

**KRBY  
FIREPLACES  
CHEMINÉES  
KAMINE  
КАМНЫ  
CAMINETTI**



**Steko** krby

# GOLEM 20



Golem 20.1

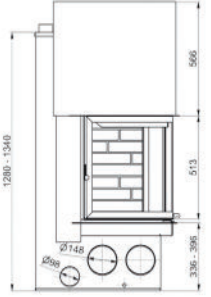
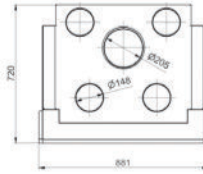

Golem 20.2 **pravé**, right, rechts, правый, droit, destro, kairinis

Golem 20.3 **levé**, left, links, левый, gauche, sinistro, dešininis

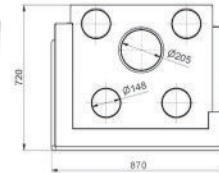

# PLUTO

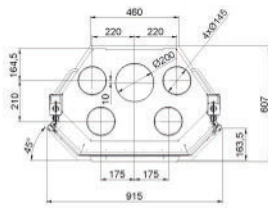

Pluto 3.3

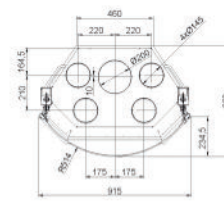

Pluto 3.8

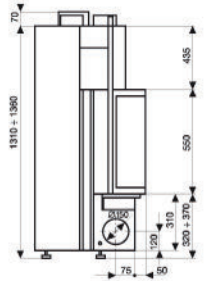
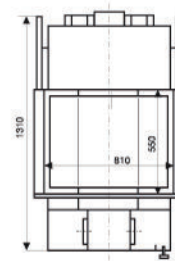

# MARS / MARS Z

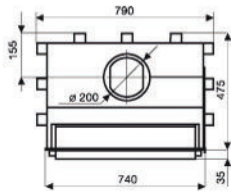

Mars 7.1

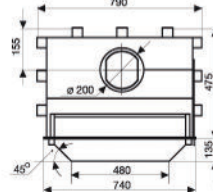

Mars 7.4

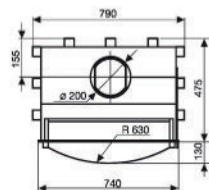
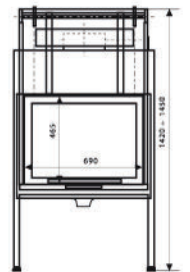
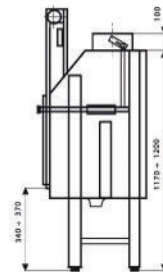

Mars 7.8

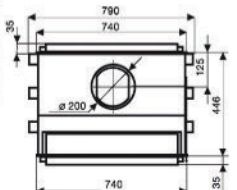
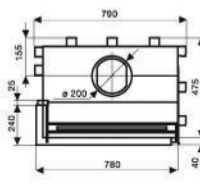

Mars 7.2 **pravé**, right, rechts, правый, droit, destro, kairinis

Mars 7.3 **levé**, left, links, левый, gauche, sinistro, dešininis

Mars 7.5 **průhledové**, reversible, durchsichtig, двустороннее, réversible, doppia faccia, du stiklai dviejuose fasaduose



**Tepl vodní výměník**, Warm-watter heating, Warmwasserheizung, Отопление горячей водой, Chauffage par l'eau chaude, Produzione aqua calda, Yra galimybė užsakyti su vandens šilumokaičiu

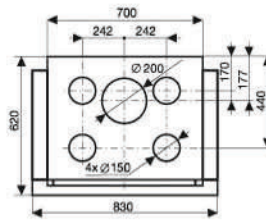

Golem 1.4

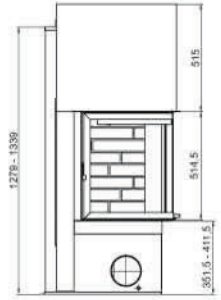

CERTIFICATES: DIN 13229; 15a B-VG, VKF SN EN 13229(B2) and AEAI SN EN 13229(B2)

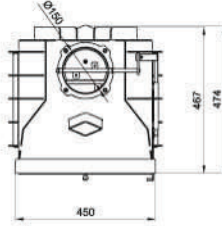

sFlow Venus 12.1W

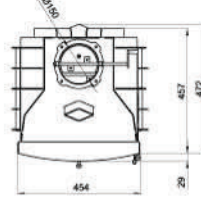

sFlow Venus 12.89

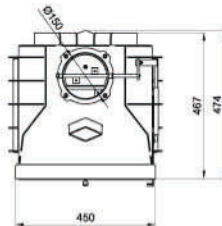
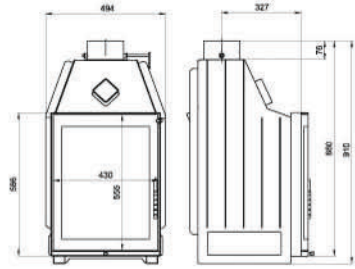

sFlow Venus 12.1

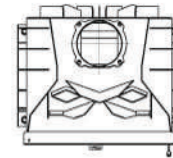

sFlow Venus 14.1/14.1R

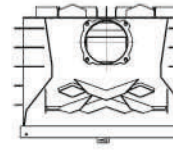
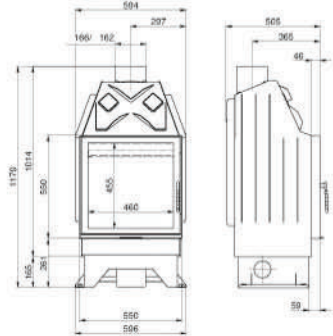

sFlow Venus 16.1/16.1R

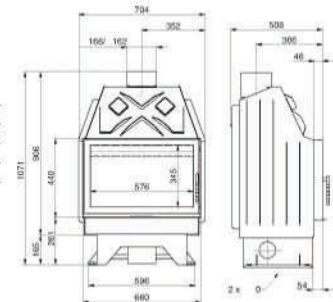

Venus 16.2/16.2R **pravé**, right, rechts, правый, droit, destro, kairinis

Venus 16.3/16.3R **levé**, left, links, левый, gauche, sinistro, dešininis

Varianta R: s popelníkem; Option R: with ash-tray; Variante R: mit Aschenlade; Вариант R - с зольником; Variante R: avec cendrier; Opcija R- su pelenine

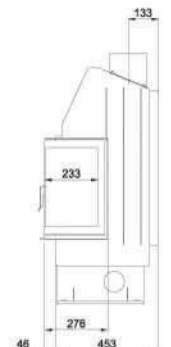
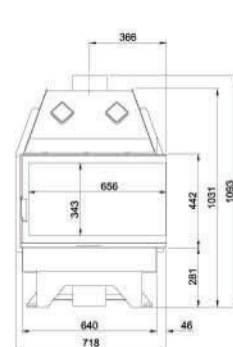

<b>Typ</b> Type Art Тип Type Modello Typ	<b>Hmotnost kg</b> Weight kg Gewicht kg Вес кг Poids kg Peso kg Masé kg	<b>Výkon kW</b> Output kW Wärmenennleistung kW Мощность кВт Puissance kW Potenza kW Galia kW	<b>Účinnost %</b> Efficiency % Wirkungsgrad % К.п.д % Efficacité % Redimento oltre % Naudingumas %	<b>Ø přípojení do komína mm</b> Ø chimney connection mm Ø Schornsteinverbindung mm Ø Присоединение мм Ø reccordament mm Ø tubo uscite fumi mm Ø dūmtr. skersmuo mm	<b>Otevírání</b> Opening Öffnung Открытие двери Ouverture Apertura Durų atvėrimas
<b>Golem 20</b> (Голем 20)	230 – 255	10 – 13	76%	200	H, V (Г, В)
<b>Golem 1.4</b> (Голем 1.4)	210	12 – 16	65%	200	H, V (Г, В)
<b>Pluto</b> (Плутто)	204 – 230	12 – 16	65%	200	H, V (Г, В)
<b>Mars</b> (Марс)	140 – 172	14 – 19	73%	200	H, V (Г, В)
<b>Venus 12</b> (Венус 12)	95 – 105	3 – 9	92%	150	H (Г)
<b>Venus 14</b> (Венус 14)	147 – 153	4 – 9	80% / R - 81%	160	H (Г)
<b>Venus 16</b> (Венус 16)	149 – 155	5 – 10	80% / R - 82%	160	H (Г)

H (Г), **horizontální**, horizontal, waagrecht, горизонтальный, horizontal, orizzontale, horizontalus. V (В) **vertikální**, vertical, senkrecht, вертикальный, vertical, verticale, vertikalus **Možnost mosazného nebo nerezového olišťování dvířek (LUX)**, Possibility of brazen or stainless-steel fire door ledge (LUX). Möglichkeit der Messing- oder Edelstahl-Türrahmenverkleidung (LUX). Возможность окантовки двери из латуни или нержавеющей стали (Люкс). Option baguette laiton ou inox (LUX). Possibilità regolo di rame o inox (LUX). Galima ugniakuro durelių apdaila - bronzinė arba nerūdijančio plieno juostelė (LUX)

## sFlow technology

**Klapka** (otevírání se při zapálení)  
Heat-up valve (it opens when making fire)

**Spaliny**  
Flue gases

**Přívod vzduchu pro oplach skla**  
(pro čištění keramického skla)  
Air inlet for the ceramic glass rinsing  
(clean ceramic glass)

**Topeniště**  
(plameny)  
Hearth  
(flames)

**Přívod vzduchu pro primární spalování**  
Air inlet of the primary combustion  
(air for combustion)

**Distribuce vzduchu pro hoření** (regulace výkonu)  
Air distribution for burning (operating element for the fireplace insert output control)

**Účinnost do 92%**  
Heating efficiency up to 92%



**Komínová klapka** (regulace tahu komína)  
Chimney valve (regulation of the chimney draught)

**Systém deflektorů** (zvyšuje účinnost)  
System of deflectors (achieving the high effectivity)

**Přívod vzduchu pro sekundární spalování**  
(CO + O<sub>2</sub> = O<sub>2</sub>)  
Air inlet for the secondary combustion

**Primární spalovací komora**  
(vzduch pro hoření)  
Primary air chamber (air for burning)

**Přívod vzduchu pro hoření do krbu**  
(možnost připojení z exteriéru)  
Air inlet for burning into the fireplace  
(possibility of joining from the exterior)

**STEKO spol. s r.o.**  
Dolní Lhota 199  
678 01 Blansko  
Czech Republic

Tel.: +420 516 427 632  
Fax: +420 516 417 154  
E-mail: krby@steko.cz



**STEKO PRAHA**  
Sladkovského nám. 3  
130 00 Praha 3  
Czech Republic

Tel.: +420 222 780 374  
Fax: +420 222 780 375  
E-mail: praha.krby@steko.cz

[www.steko.cz](http://www.steko.cz)

